

Point Lonsdale Garden

The current owners of the Winterly Road garden came to Eckersley Garden Architecture in 2015. They had recently purchased the property and had plans to rebuild the house, working with the renowned Melbourne architects, Robson Rak.

The garden however was to be retained as much as possible. The previous owner had been a keen gardener and an avid collector of unusual plants. She made a hobby of visiting nurseries and buying unique and wonderful specimens for Winterly Road.

Probably the most spectacular of these original plants was a fruiting fig tree (*Ficus carica*) that had been espaliered against the original home but had grown so large it was now free-standing.

Being a coastal environment, the original garden also featured a wonderful array of Moonahs and tea trees existing as street trees.

EGA designed the garden around the new rammed earth home and the existing trees. It made sense to divide the space into five distinct areas, all with their own atmosphere, inviting visitors on a delight-filled journey. The finished result is a layered garden, full of variety and interest.

A. Streetscape

The native street trees have been used to create the effect of extending the front garden into the borrowed landscape of the nature strip. Additionally the decidedly coastal feel of the front garden sets up a wonderful surprise for visitors as they progress through the garden paths into the garden spaces.

B. The lawn and original collectors garden

Visitors will notice that the collectors garden has been added to, using a textural mix of leaf forms, strap-leaved grasses and groundcovers, layered densely with the many established trees.

C. The pool and entertaining space

The owners have a large generational family and this area provides ample space for everyone to be together, particularly during the holidays. The pool fence is partially hidden as it weaves its way through layered garden beds.

D. Potager garden

Raised concrete cylinder garden beds were installed to make vegetable gardening easy to establish and harvest.

E. Rear native garden

This low maintenance space provides a private outlook from the home's guest bedrooms connecting to the neighbouring landscape consisting of Moonahs.

GARDEN NOTES

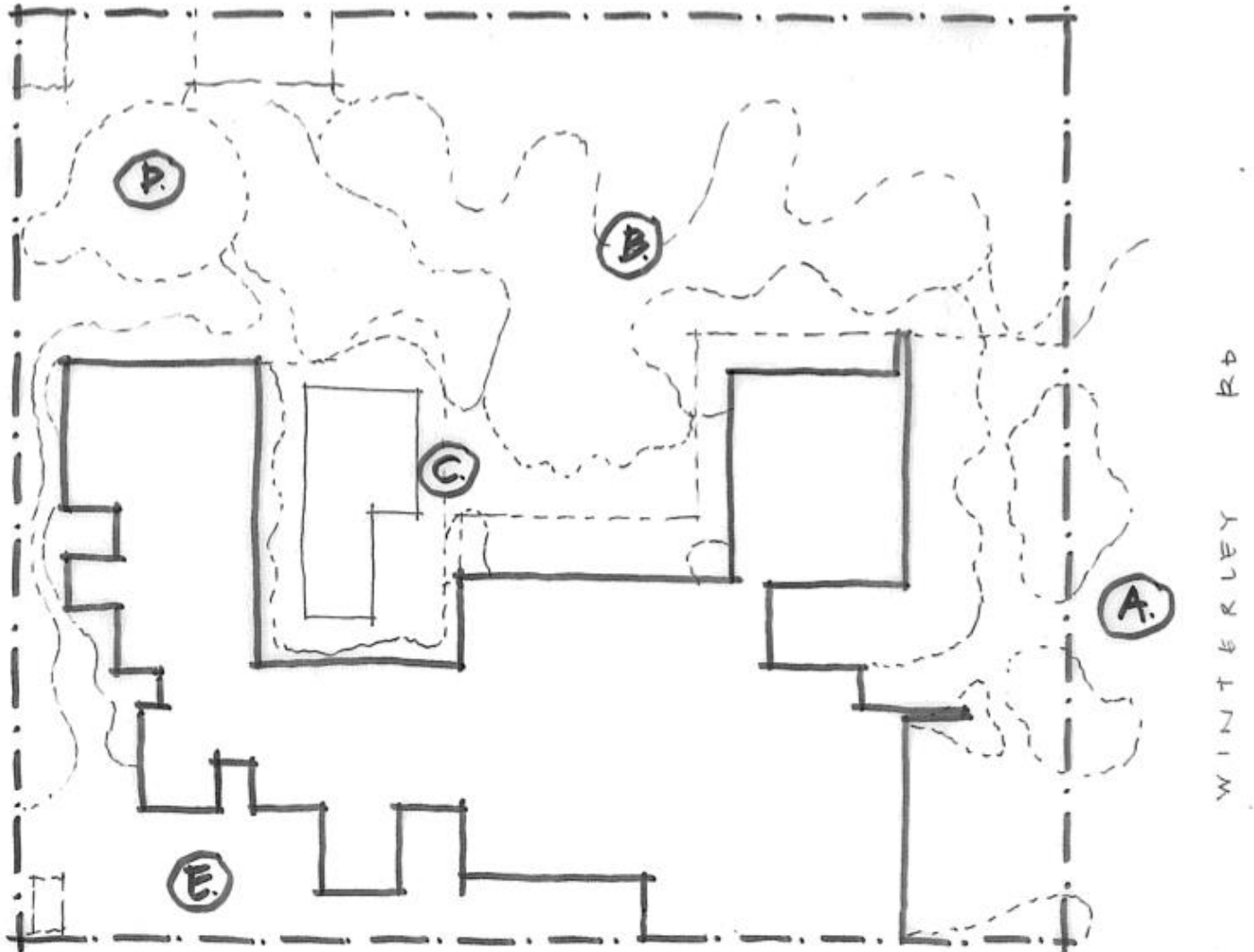

Point Lonsdale Garden is located on the lands of the Wadawurrung People. Open Gardens Victoria wishes to acknowledge the Traditional custodians of this land and we pay respect to their Elders, past, present and emerging.

**These notes can be downloaded from the Open Gardens Victoria website:
www.opengardensvictoria.org.au**